

millimetres
inches

Bayonet

Made of electro plated steel, this nipple is provided with a projecting cross pin to engage with helical slots in the bayonet connector, part number HF 4006/1.

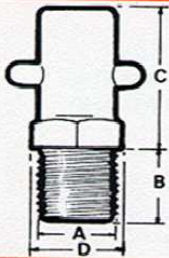

Thread A	Dim. B	Dim. C	Dim. D	Part No.
1/8" B.S.P.F.	9.7 .38	18.2 .72	11.1 .437	NE 6200
1/8" - 27 N.P.T.	9.7 .38	18.2 .72	11.1 .437	NE 6201

Tecazerk

Made of case hardened electro plated steel, this compact nipple is also ideally suited for applications where space is limited. It is used extensively on motor cycles, bicycles, door hinges, lawn mowers and other small mechanisms. Use connector part number HF 4014 for servicing.

STRAIGHT

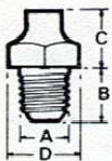

2BA	3.5 .14	6.8 .27	6.4 .250	NC 6055
1/4" B.S.F.	5.7 .22	7.2 .28	8.0 .312	NC 6057
1/4" B.S.F.	4.4 .17	7.0 .28	7.0 .28	NC 6059
3/16" - 32 B.S.C.	3.5 .14	6.8 .27	6.4 .250	NC 6056
1/8" B.S.P.F.	6.9 .27	7.5 .30	11.1 .437	NC 6065
1/4" - 28 U.N.F.	5.7 .22	7.2 .28	8.0 .312	NC 6100
3/16" nom Drive fit	4.9 .19	4.2 .17	6.4 .250	NC 6089*

All drive fit nipples are manufactured from round bar, and dimension D equals bar diameter.

65° ANGLE

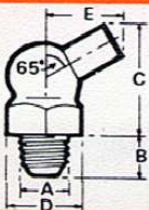

Thread A	Dim. B	Dim. C	Dim. D	Dim. E	Part No.
1/4" B.S.F.	5.7 .22	11.9 .47	9.3 .365	10.0 .39	NC 6050

Lub Plug

Made of electro plated steel, this nipple is designed for use where minimum surface projection is required. See Dim. 'C'. Use connector part number HF 4034 for servicing.

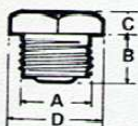

1/8" B.S.P.F.	6.4 .25	2.9 .11	10.5 .413	NF 6250
1/4" nom Drive fit. Overall height (Not illustrated)	9.3 .365 without shoulder			NF 6256